

Upload and Download Files

Prerequisites



Menu option **Upload and Download Files** needs to be enabled via the Lite config file

File Upload Process

Select Upload And Download File from the **Task Menu** and click Next to continue.

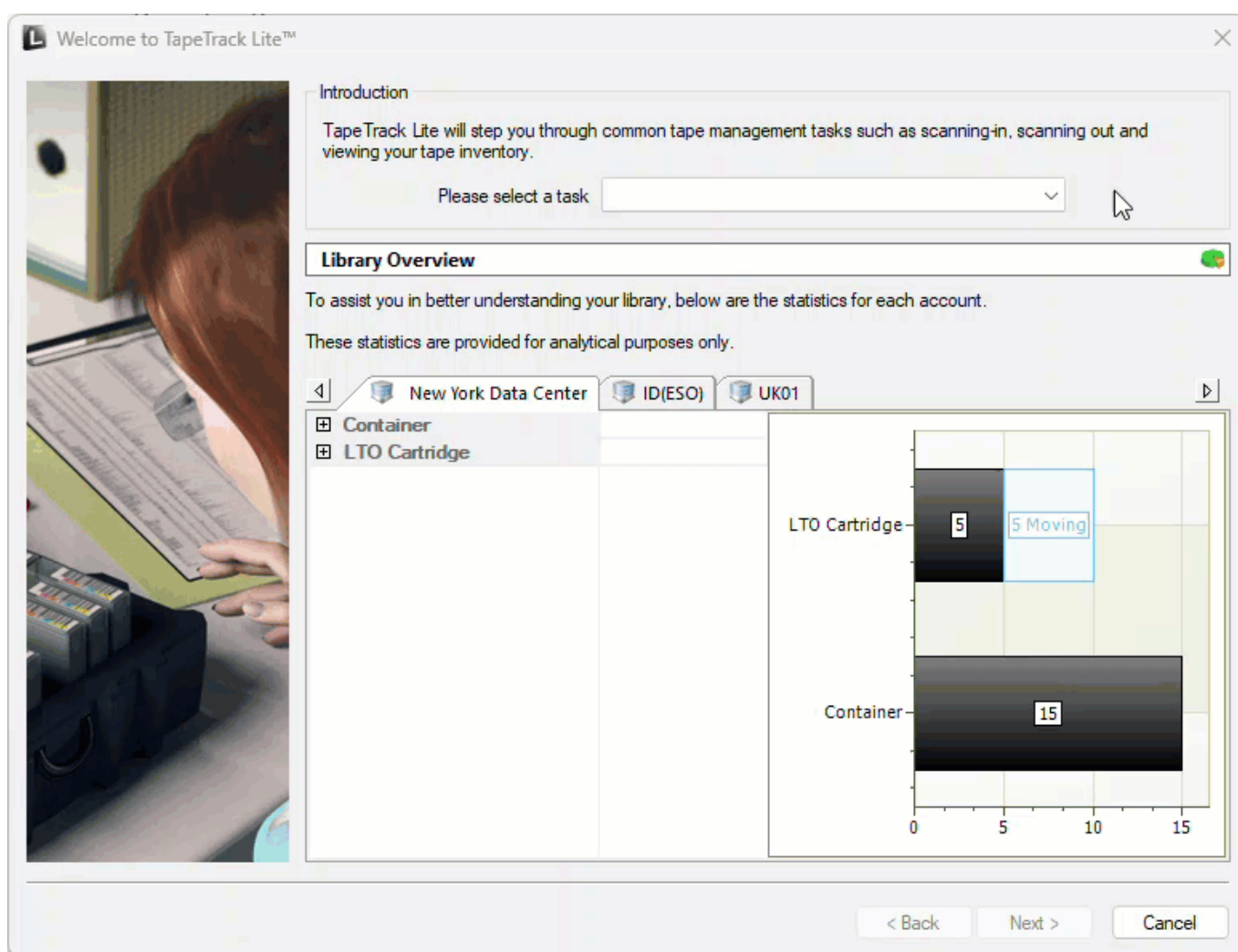

Options

This will open the **Options** window. If required you can change the location for the log files to be written to, or leave the default.

To change the default directory, click in the field to the right of the Log File Folder and click on the (...)

button, select the required directory and click OK to save.



Setting the directory location in the Lite configuration file will skip this window and write the log file to that location.

Click Next to continue.

TapeTrack Lite™ - Options

Instructions

The Options screen allows you to specify options that will influence how future screens perform.

The options you change will be retained for future sessions.

General Options

Log File Folder C:\Users\diffi\Documents

< Back Next > Cancel

From:

<https://rtfm.tapetrack.com/> - TapeTrack Documentation

Permanent link:

https://rtfm.tapetrack.com/lite/function_upload?rev=1699236212

Last update: 2025/01/21 22:07

